



**The style you have desired,  
the safety you have dreamed**

## **New Color TFT-LCD Video Door Phone SHT-3005**

There are things just right for you who deal only the best. From house, car, even to pen... each and every thing should signify your nobility. So, to you, we present a blue illuminator video door phone. EZON video door phone will make your living room a ennobled space.



**EZON**'s video door entry system brings advanced innovative technology direct to your home and office. Simple installation and high performance means you need look no further to find the ideal video door entry solution.

**Feature**

- Superior 5 inches color TFT-LCD screen
- Expandable up to 4 monitors and 3 door cameras
- Intercom features between video monitors
- Convenient touch pad control : first video door phone with sensitive blue icons
- Brightness and volume controls with OSD menu
- Remote door release function : optional electric strikers needed
- Emergency alarm will activate in the event of intrusion detection by magnetic door sensor
- 32 cuts picture memory : door cameras take photo of visitors in your absence and you can playback the image. (model #. SHT-3005XR)
- Real-time video monitoring in each door camera's front view
- Camera angle adjustable (model #. SHT-CN510)



**Configuration**

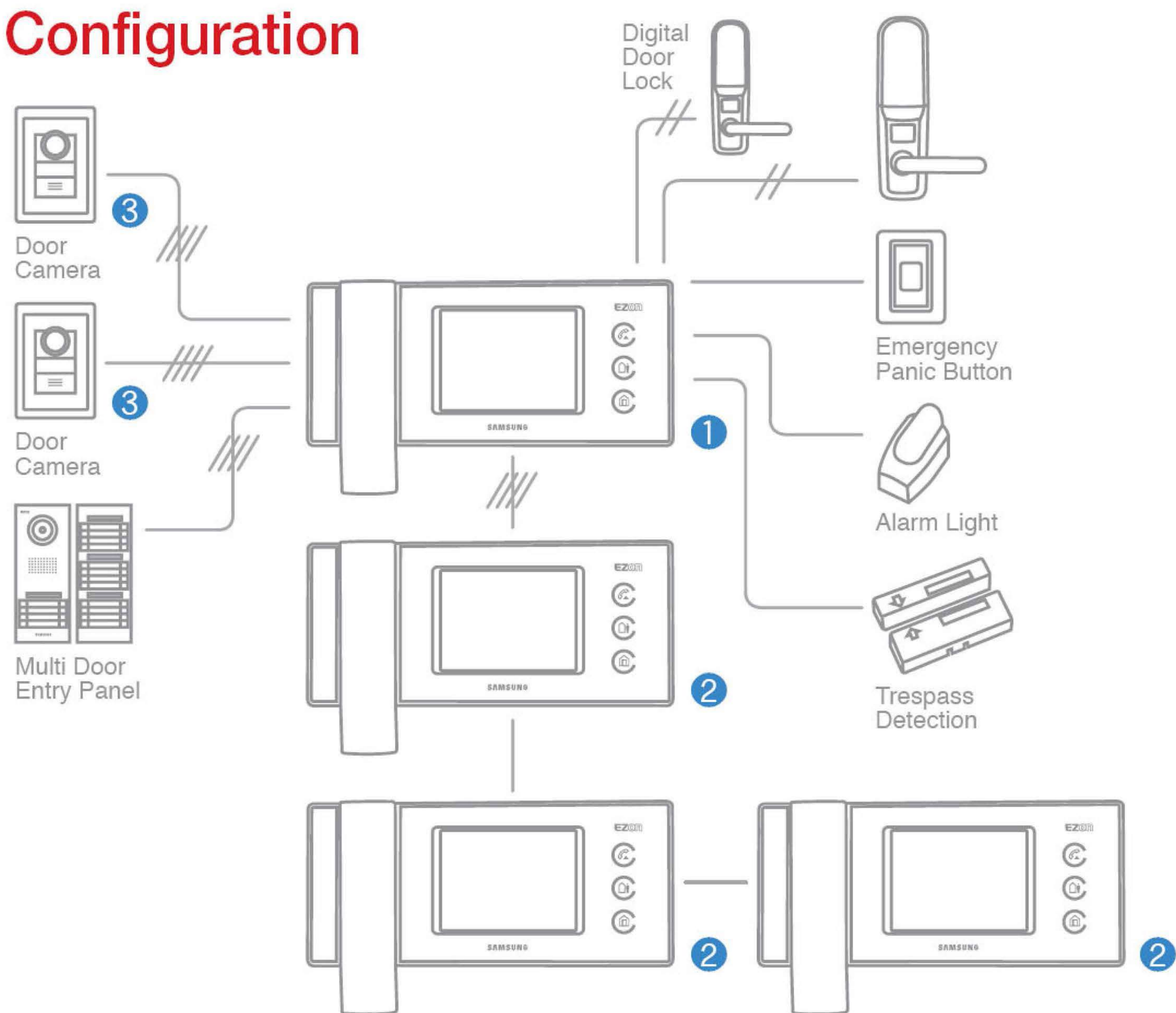

**Design**

For users who enjoy cutting-edge style, the new SHT-3005 offers a sleek and stylish black wide mirror screen and stunningly slim 40mm. It also has side accents in metallic silver lend a subtle sophistication to the fashion phone. At the same time, the curved handset is designed for a grip that feels good in your hand. Its modern and elegant design concept and user-friendly blue illuminators put this model as a design triumph.



**Specifications**

Mode	SHT-3005
Power	AC 110V~ 220V° ± 20%, 50/60Hz
Power Consumption	20W
Display	5" TFT-LCD Color
Wiring	4 wires
Dimension	275(W) x 125(H) x 40(D)mm
Weight	1.2 kg
Installation	Wall mounting type

Mode	SHT-CN510
Power	DC 12V from Monitor
CCD	1/3" Color 270K pixels
Dimension	92(W) x 136(H) x 12(D)mm
Installation	Flush mounting type

**Model**

SHT-3005XA	Main Monitor with Camera kit (1+3)
SHT-3005XM	Main Monitor (1)
SHT-3005EA	Sub Monitor with Camera kit (2+3)
SHT-3005EM	Sub Monitor (2)
SHT-3005XR	Main Monitor (Picture Memory) with Camera kit (1+3)
SHT-CN510	Camera (3)



HCS Security Technology Pvt. Ltd.  
Siddhi Bhawan, Jamal, Kathmandu, Nepal  
Tel # 4-260622, Fax # 4-267810  
Email: sales@harati.com.np



SHT-3005